



Installation Instructions

All parts necessary for installation are supplied except the guide pipe:

Round Pipe – 2 inch (60.3mm OD), galv. steel or plastic, or 50NB DWV (56mm OD) plastic

Square Tube – 2 inch (50.8mm) and 50mm square, thin wall, steel or aluminium.

Preparation

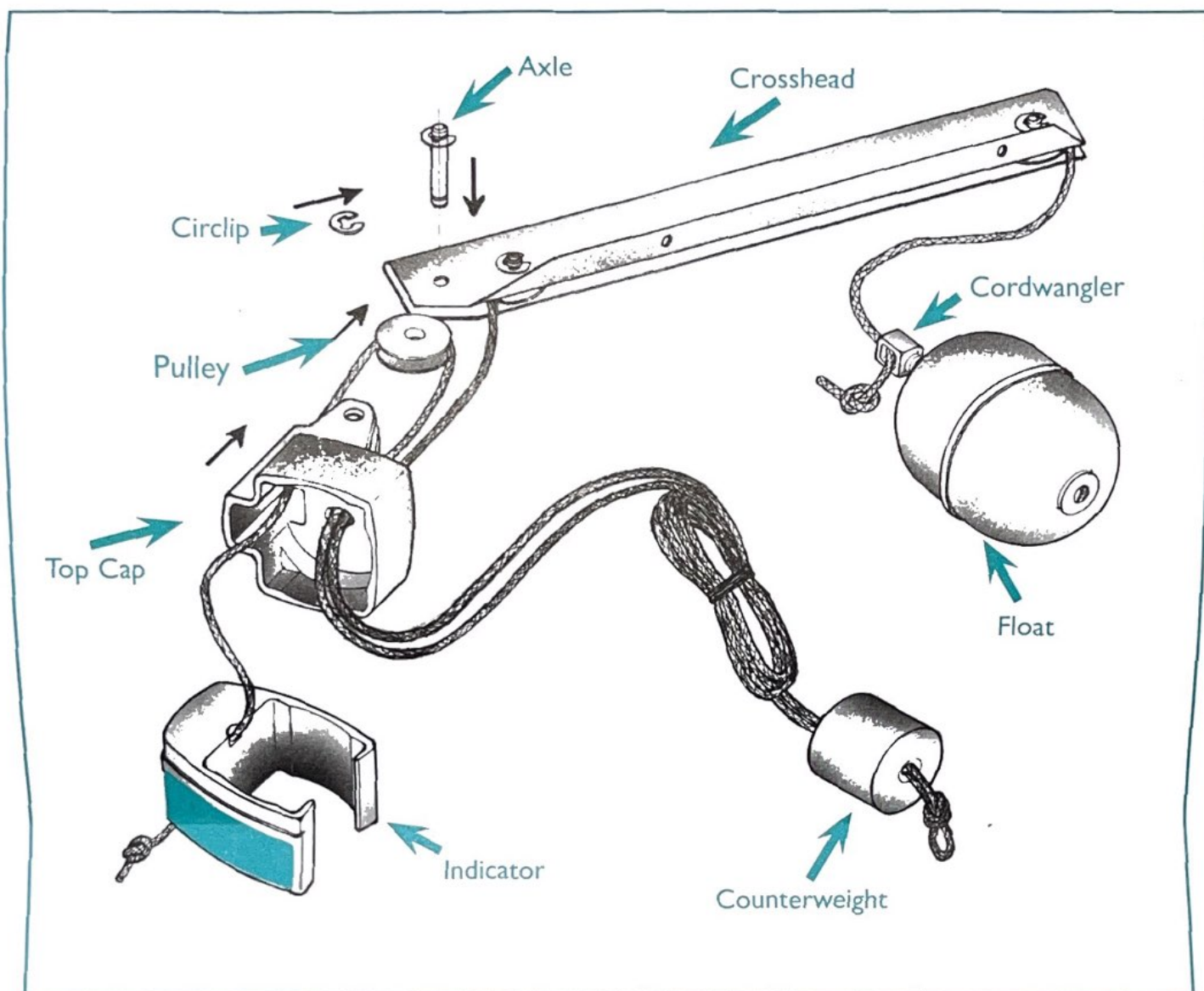

1 Unpack and lay the components neatly on a bench

For clarity, the above diagram is an "exploded" view of the Liquidator.

(Bottom Cap is not shown.)

Unfold the cord hank making sure the cords are free from twists.

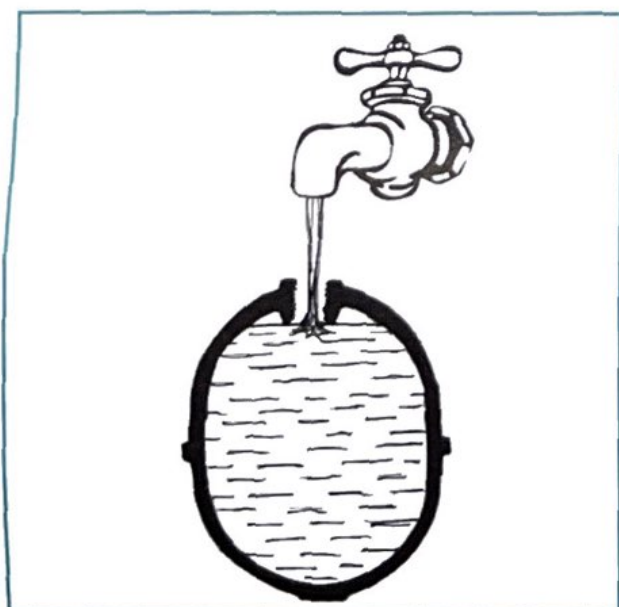

2 Fill Float

The float must be filled with water (to provide enough weight for correct balance).

Unscrew "Cordwangler" insert and hold the hole in the float under a steady stream from a tap until completely full.

Installation - Follow Steps 3 to 9 in Sequence

- 3** Mount the stainless steel crosshead on tank roof using the 2 stainless steel self-tapping screws, drilling tank roof to suit. It should overhang such that the pipe/tube clears the tank.

- 4** Drill float cord hole
The hole must be big enough to prevent chafing - about 10 to 20 mm ($\frac{3}{8}$ " to $\frac{3}{4}$ " diameter).

- 7** Thread float cord through its hole in the tank roof, re-tie it to the float Cordwangler, and let the float hang freely.

- 6** Erect pipe/tube
Insert the pipe/tube in the Bottom Cap and stand it up beside the tank, mark and cut it to length, allowing correct length of engagement inside the Top Cap (10mm ($\frac{3}{8}$ ") for 50NB (2 inch) round pipe, 22mm ($\frac{7}{8}$ ") for 50mm (2 inch) square galvanized steel tube and 56mm (2.2") OD PVC round pipe.) Insert counterweight and let it slide down inside. Slip the indicator over the outside of the pipe/tube and let it slide down too. Stand pipe/tube in bottom mounting, then push on Top Cap. (Temporarily loosen Crosshead to allow room to manoeuvre.)

- 8** Adjust float cord length
With the counterweight fully down the float should be fully up. Shorten float cord as necessary by pulling it through the counterweight until float is fully up, then re-tie the knot.

- 9** Adjust indicator cord length
Simply pull its cord through until the red band on the indicator is at the same height as the centre of the float, re-tie the knot, and cut off excess cord.

- 5** Prepare bottom mounting
For tanks on ground the simplest way is to dig a small hole and pack the earth around the bottom of the pipe. (Concrete can be used instead of earth backfill.)

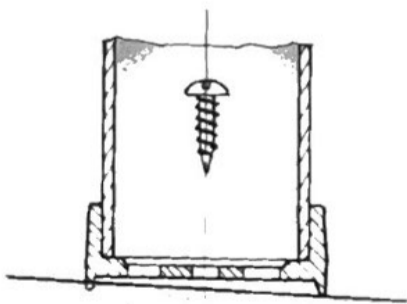
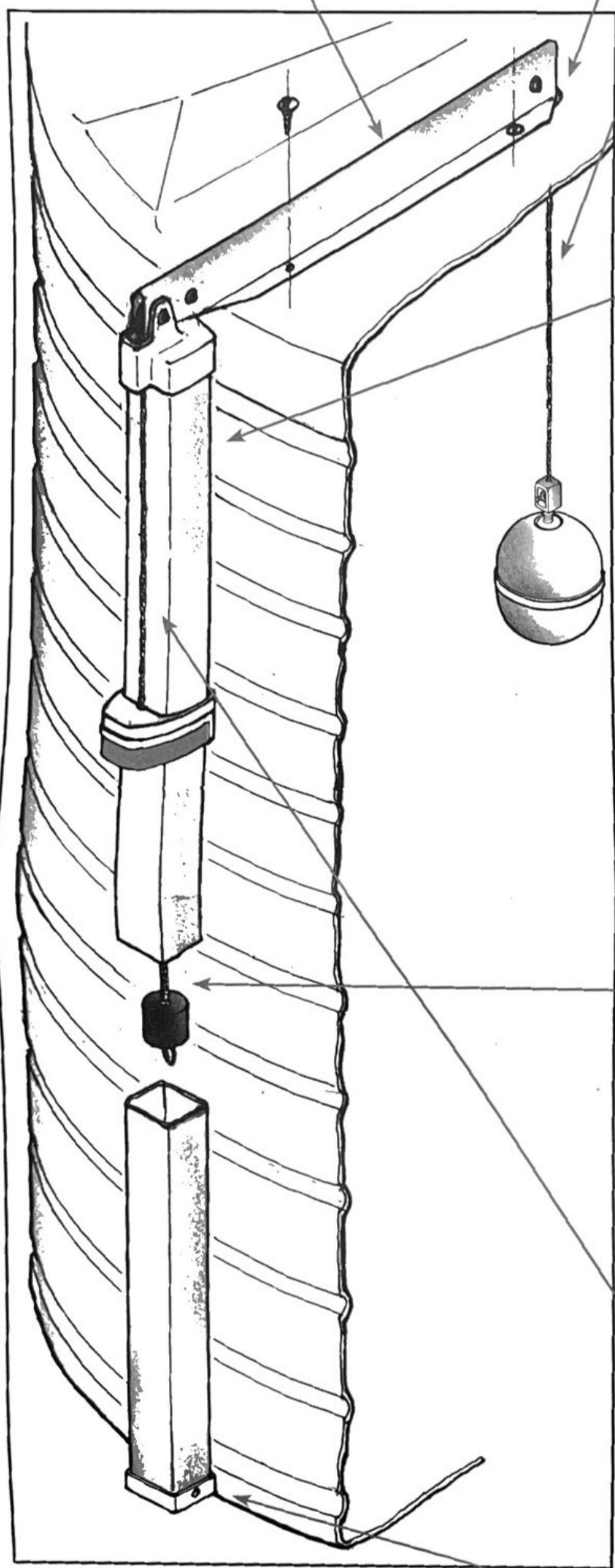

For tanks on a base the simplest way is to fix the Bottom Cap to the floor. The thin rim on the underside of the Bottom Cap can be filed or ground away to suit a sloping floor.

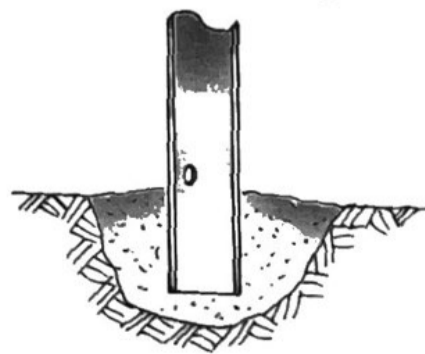

Allowing the counterweight to hang like a plumb bob is a convenient way to make sure the guide pipe is vertical and to mark the position of the Bottom Cap & screw.